

2025

# VICTORIA

TARIFF | BREAKS FOR ALL SEASONS  
SOURCE SPA & WELLNESS



*Perfectly located, overlooking Sidmouth's beautiful esplanade, The Victoria Hotel is a flagship of the Brend Collection. With glorious sweeping views of Lyme Bay, this magnificent luxury hotel epitomises our traditional values of superb quality, sumptuous cuisine and stunning setting.*



## WELCOME

---

Welcome to our 2025 tariff which includes our Room Only, Children's and Breaks for all Seasons

---

The Victoria Hotel offers a truly unique experience where traditional charm meets world-class service. Plus, with an abundance of leisure facilities and activities for all ages, it makes for the perfect base for your next getaway.

2024 has been a monumental year for The Victoria Hotel with the completion of our all new Source Spa. With a £1.5 million investment our spa now boasts a heated indoor pool, sauna, steam room, spa bath, relaxation area and gym. Plus, a new secondary lift giving guests direct access from bedroom to spa in both lifts.

The Belmont, our adjacent sister hotel, is making a change from the 2nd January onwards to adults only. Children under the age of 18 unfortunately will not be permitted to stay overnight. However, on special family occasions, children will be allowed to attend lunches and teas between 11.30am - 6pm.

As ever, we would like to thank you for your support during 2024, and the team and I look forward to welcoming you back in 2025.

*Matthew Raistrick*

Matthew Raistrick, Area Director



## THE HOTEL WITH EVERYTHING



The Victoria Hotel is ideally located in the traditional Regency resort town of Sidmouth.

There really is something for everyone! From indoor and outdoor heated swimming pools, to an 18-hole putting green, tennis court, resident quartet, and free children's entertainment in the school holidays. Add to this, the superlative levels of service for which Brend Collection are renowned, and you have a winning formula that few hotels can match.

## ROOM ONLY TARIFF 2025

ROOM CATEGORY	WINTER 2 Jan - 16 Apr & 12 Oct - 22 Dec	SPRING 17 Apr - 21 May	SUMMER 22 May - 13 Sep	AUTUMN 14 Sep - 11 Oct
Standard Double Room	285	315	375	325
Garden / Partial Sea View Double or Twin	325	375	415	385
Sea View Double or Twin	355	405	455	405
Superior Double or Twin	375	425	475	425
Deluxe Double or Twin	405	475	525	485
State Double or Twin	455	515	585	535
Suite Double or Twin	525	585	645	605
Standard Single	170	195	215	195
Deluxe Single	175	205	230	205

Prices are per night, room only, inclusive of VAT at the current rate. Prices are correct at the time of going to print. Please check our website or call us for live prices and availability. Excludes Christmas, New Year, Poolside Suites, and Family Summer Tariff.

# BREAKS FOR

# ALL SEASONS

WINTER 2025 2 January - 16 April 12 October - 22 December inclusive	ROOM & BREAKFAST		DINNER, ROOM & BREAKFAST		
	1 NIGHT	2+ NIGHTS	1 NIGHT	2-4 NIGHTS	5+ NIGHTS
Standard Double Room	155	145	185	175	165
Garden / Partial Sea View Double or Twin	175	165	205	195	185
Sea View Double or Twin	190	180	220	210	200
Superior Double or Twin	200	190	230	220	210
Deluxe Double or Twin	215	205	245	235	225
State Double or Twin	240	230	270	260	250
Suite Double or Twin	275	265	305	295	285
Standard Single	185	175	215	205	195
Deluxe Single	190	180	220	210	200
	ROOM ONLY				
	1 NIGHT		2-4 NIGHTS		5+ NIGHTS
Poolside Suite	325		315		305

SUMMER 2025 22 May - 13 September inclusive	ROOM & BREAKFAST		DINNER, ROOM & BREAKFAST		
	1 NIGHT	2+ NIGHTS	1 NIGHT	2-4 NIGHTS	5+ NIGHTS
Standard Double Room	200	190	230	220	210
Garden / Partial Sea View Double or Twin	220	210	250	240	230
Sea View Double or Twin	240	230	270	260	250
Superior Double or Twin	250	240	280	270	260
Deluxe Double or Twin	275	265	305	295	285
State Double or Twin	305	295	335	325	315
Suite Double or Twin	335	325	365	355	345
Standard Single	230	220	260	250	240
Deluxe Single	245	235	275	265	255
	ROOM ONLY				
	1 NIGHT		2-4 NIGHTS		5+ NIGHTS
Poolside Suite	440		430		420

SPRING 2025 17 April - 21 May inclusive	ROOM & BREAKFAST		DINNER, ROOM & BREAKFAST		
	1 NIGHT	2+ NIGHTS	1 NIGHT	2-4 NIGHTS	5+ NIGHTS
Standard Double Room	170	160	200	190	180
Garden / Partial Sea View Double or Twin	200	190	230	220	210
Sea View Double or Twin	215	205	245	235	225
Superior Double or Twin	225	215	255	245	235
Deluxe Double or Twin	250	240	280	270	260
State Double or Twin	270	260	300	290	280
Suite Double or Twin	305	295	335	325	315
Standard Single	210	200	240	230	220
Deluxe Single	220	210	250	240	230
	ROOM ONLY				
	1 NIGHT		2-4 NIGHTS		5+ NIGHTS
Poolside Suite	335		325		315

AUTUMN 2025 14 September - 11 October inclusive	ROOM & BREAKFAST		DINNER, ROOM & BREAKFAST		
	1 NIGHT	2+ NIGHTS	1 NIGHT	2-4 NIGHTS	5+ NIGHTS
Standard Double Room	175	165	205	195	185
Garden / Partial Sea View Double or Twin	205	195	235	225	215
Sea View Double or Twin	215	205	245	235	225
Superior Double or Twin	225	215	255	245	235
Deluxe Double or Twin	255	245	285	275	265
State Double or Twin	280	270	310	300	290
Suite Double or Twin	315	305	345	335	325
Standard Single	210	200	240	230	220
Deluxe Single	220	210	250	240	230
	ROOM ONLY				
	1 NIGHT		2-4 NIGHTS		5+ NIGHTS
Poolside Suite	350		340		330

Room and breakfast and dinner, room and breakfast prices shown are per person, per night, are inclusive of the terms stated and VAT at the current rate. Based on two people sharing a double or twin room. The dinner, room and breakfast package includes a 5-course table d'hôte dinner. Poolside suite prices are shown per suite, per night, Room Only.

To make a booking call 01395 512651 or visit [www.victoriahotel.co.uk](http://www.victoriahotel.co.uk)



## PERFECT FOR FAMILIES



Only 200 yards from Sidmouth's lovely beach and just a short walk to the town centre, we're in an ideal location for a family holiday.

Whatever the weather, you'll find a whole host of activities right here at the hotel and around the area that will keep the whole family happy. Families have stayed at the Victoria Hotel for generations with many parents and grandparents returning with their families, having first visited the Victoria Hotel as a child themselves!

## CHILDREN'S TARIFF 2025

2 January to 22 December 2025 - includes dinner, room and breakfast.

ROOM CATEGORY	3 & UNDER	4-8 YEARS	9-15 YEARS
Sharing Parents' Room	FREE	65	85
Children's Room (bunk beds or extra bed)	25	85	90
Children sharing Garden or Partial Sea View Room	-	95	105

## CHILDREN'S DINING

2 January to 22 December 2025. Children's High Tea 5:15 to 6:00pm. Please order at Reception.

DINING OPTIONS	3 & UNDER	4-8 YEARS	9-15 YEARS
Breakfast	FREE	10	15
Children's Tea	FREE	17	17
Children's Dinner	FREE	22	27

## FAMILY SUMMER 2025

20 July - 30 August 2025 Inclusive

ROOM CATEGORY	2-4 NIGHTS	5+NIGHTS	7+ NIGHTS*
Standard Double Room	220	210	200
Garden / Partial Sea View Double or Twin	240	230	220
Sea View Double or Twin	260	250	240
Superior Double or Twin	270	260	250
Deluxe Double or Twin	295	285	275
State Double or Twin	325	315	305
Suite Double or Twin	355	345	335
Standard Single	250	240	230
Deluxe Single	265	255	245
	ROOM ONLY		
	2-4 NIGHTS	5+ NIGHTS	7+ NIGHTS*
Poolside Suite	430	420	410

Prices shown are per person, per night, based on two people sharing a double or twin room, and are inclusive of room, full English breakfast, and 5-course table d'hôte dinner. All room rates quoted are inclusive of VAT at current rate. Prices are shown in £ sterling. \*These special family rates are available to family parties of 3 or more holidaying between 20th July and 30th August and incorporate our entertainment Programme. Stay must include Sunday to Sunday. Please note: The entertainment Programme may change and management reserve the right to amend the Programme as necessary without prior notification. Luxury Poolside Suites suitable for up to 2 adults and 2 children. Poolside Suite prices are shown per suite, per night, Room Only.

To make a booking call 01395 512651 or visit [www.victoriahotel.co.uk](http://www.victoriahotel.co.uk)

# SUMMER ENTERTAINMENT PROGRAMME



## SUNDAY

### FROM 6.30PM | DINNER

Join us for dinner.

### AFTER DINNER | BINGO

Take part in our Charity Bingo. £2 per card entry with all the proceeds going to the Devon Air Ambulance.

## MONDAY

### 11.00AM | TENNIS COMPETITION

Come and test your racquet skills on the court to compete for 'top shot'.

### 3.00PM | BATTLE GOLF

Pitch your way to success.

### FROM 6.30PM | A MAGICAL DINNER

Enjoy the relaxing sounds of our Resident Pianist whilst you dine in The Jubilee Restaurant, and be astounded by close-up magic from Gary Jones.

## TUESDAY

### 10.00AM - 1.00PM | ARCHERY

Test your skills at this ancient sport and aim for gold on the front lawn with our 'have a go' archery.

### 6.30PM ONWARDS | CARICATURIST

Sarah Bailey, our Caricaturist, will be in the lounge until 9.00/9.30pm.

### FROM 6.30PM | DINNER

Dinner in the Jubilee Restaurant is accompanied by the sounds of The Victoria Quartet.

### AFTER DINNER | TAKE TO THE DANCE FLOOR

Martin King's disco takes over in the Sun Lounge for a night of music and dancing.

## WEDNESDAY

### 11.00AM | GIANT JENGA COMPETITION

Rise to the top and try your hand at our giant Jenga competition.

### 3.00PM | TABLE FOOTBALL COMPETITION

Fancy becoming a 'foozball champ'?

### FROM 6.30PM | DINNER

Dinner in the Jubilee Restaurant is accompanied by the relaxing sounds of our Resident Pianist.

### AFTER DINNER | QUIZ NIGHT

Join us in the Sun Lounge for a chance to test your knowledge at our quiz night. A team quiz suitable for all ages with prizes for 1st, 2nd and 3rd place.



## THURSDAY

### 11.00AM | THE VICTORIA MASTERS

'Putt' your golfing skills to the test in our 18-hole putting competition.

### 1.00PM | POOL COMPETITION

Be the one to pot the '8 Ball' and become our pool champion!

### FROM 6.30PM | DINNER

Dinner in the Jubilee Restaurant is accompanied by the sounds of The Victoria Quartet.

### AFTER DINNER | RACE NIGHT

Join us in the Sun Lounge for our charity race night. See if you can back any winners tonight! All proceeds go to the Devon Air Ambulance.



*Please note: Subject to change. Management reserves the right to amend the entertainment programme as necessary without prior notification.*

## FRIDAY

### 10.00AM - 1.00PM | LASER CLAY PIGEON SHOOTING

A safe way for all to enjoy the sport. It uses sensors to keep scores and sound effects to make the experience more realistic.

### 3.00PM | TABLE TENNIS TOURNAMENT

Take to the tables to see if you can become our Table Tennis Champion.

### FROM 6.30PM | DINNER

Dinner in the Jubilee Restaurant is accompanied by the relaxing sounds of our Resident Pianist.

### AFTER DINNER | CASINO NIGHT

Take the tokens found on your table at dinner into the Sun Lounge and place your bets for your chance to claim the prize!



## SATURDAY

### 11.00AM | THE VICTORIA MASTERS

Another chance to 'putt' your golfing skills to the test at The Victoria Masters, our 18-hole putting competition.

### FROM 6.30PM | DINNER

Dinner in the Jubilee Restaurant is accompanied by the sounds of The Victoria Quartet.

### AFTER DINNER | COASTLINE

It's time to dance the night away to the sounds of our fabulous Resident Band, 'Coastline' in the Sun Lounge.



## DINING OPTIONS

At the Victoria Hotel, we know that no matter how delicious we make our menu, our guests won't return to us year after year unless we deliver an overall outstanding dining experience.

Experience the best of both worlds, fine dining in our AA Rosette award-winning Jubilee Restaurant, or savour contemporary dishes influenced by classic French cuisine in our White Room. Whether you're a seafood fanatic, veggie lover or dessert devourer – you'll be spoilt for choice over our variety of delicious dishes.

### Dress Code

#### Jubilee Restaurant

In the evening we have a preference for jacket & tie, but smart casual is accepted (no ripped denim, sportswear, beachwear or trainers).

#### The White Room

Smart casual (no beachwear).



## BERTIE'S BAR



Let the warm and inviting atmosphere of our Bertie's Bar relax you after a long day enjoying Devon.

Named after King Edward VII (Bertie) as he, like us, loved a drink or two, we know our quirky bar is a hit with all.

The perfect setting to sit back, relax and mull over the wonderful day you've had discovering Sidmouth. You will love the warm and inviting atmosphere of our luxury Bertie's Bar, a wonderful setting in which to enjoy a refreshing drink, light lunch and some lively conversation with friends.





# source spa

## NOW OPEN

After 6 months of construction, we are delighted to announce that our Spa is officially open, the second Source spa within the Brend Collection.

The spa, which is accessed by two lifts, features a heated indoor pool, a hydrotherapy spa bath, an aroma sauna and a steam room, all meticulously designed to promote health and tranquillity. Additionally, our modern gym is equipped with the latest fitness technology, ensuring a comprehensive wellness journey for our guests.

The relaxation area provides a serene setting to unwind, while our two treatment rooms offer a diverse range of Source spa treatments, crafted to rejuvenate both body and mind.

Around the traditional school holiday dates, children will be using the indoor pool.

**Opening Times 8am to 7pm**

*“It is with absolute pleasure we can say the Source Spa at The Victoria is now open. It’s been a journey from planning through to completion. A huge thank you to all those involved and the Brend family of Directors and in particular to Mr. Matthew Brend for his massive involvement in the day-to-day details of making this possible. Thank you to all our guests for their understanding and patience. It really is stunning so please come and see it for yourself.”*

**Matthew Raistrick, Area Director**





# source spa

## TREATMENTS

Steal yourself away for some precious moments of calm, indulgence and revitalisation with a spa treatment.

Envelop yourself in a cosy robe and let our therapists take you to another world. Our spa treatment menu has been carefully created to make you feel good on the inside and outside. We use a handpicked portfolio of products to complement our range of spa treatments, including our very own cruelty-free Source Spa Collection.

To book, call 01395 576006  
Opening Times 8am to 7pm



Scan the QR Code to view  
our full list of treatments





# VICTORIA LIDO

Everything you need in one place:

- Large heated outdoor swimming pool (open May to September)
- A smaller children's pool (open May to September)
- Sun loungers
- The Pavilion Bar with a games room, pool table and table tennis
- Luxurious towels
- Ladies' and gentlemen's changing room, lockers and shower facilities

Opening Times 8am to 7pm





## POOLSIDE SUITES GET HOT TUBS

Our Poolside Suites had an exciting upgrade in 2024.

Last summer, our Poolside Suites boasted new luxurious hot tubs, providing an indulgent way to relax while enjoying breathtaking views over our Outdoor Pool. Imagine soaking in the warm, soothing waters as you unwind after a day of exploring, or spending a serene evening under the stars with the perfect blend of comfort and tranquility.

These modern hot tubs ensure optimal comfort with adjustable temperature and jet settings, allowing you to customise your relaxation experience to your exact preferences. Whether you seek a gentle, calming soak or a more invigorating massage, our hot tubs cater to all your needs.

In addition to the hot tubs, our Poolside Suites offer a range of exceptional amenities to enhance your stay. Enjoy the convenience of a private poolside terrace, complete with sun loungers and outdoor seating, perfect for basking in the sun. Inside, the suites feature a separate living area, a comfortable sofa bed, and a small kitchen area, providing the independence and flexibility you desire during your stay.



















*A minimum 3-night stay is required for hot tub use.*



# LUXURY ACCOMMODATION

SOME OF THE BEST LUXURY HOTEL ROOMS YOU COULD FIND. EVERY ROOM HAS ITS OWN AMBIENCE AND MANY HAVE TRULY SPECTACULAR SEA VIEWS.

All rooms are en suite with Wi-Fi, LCD TV with Sky Sports, water, tea & coffee making facilities, luxury toiletries, dressing gowns and a hair dryer. Luxury extras including freshly cut flowers, chocolates and fresh fruit are provided in a selection of our rooms, but each of these items can also be ordered by any of our guests prior to arrival.

Balcony	
Stunning Views	
En-suite with Bath	
Walk-in Shower	
TV with Sky Sports & Freeview	
Seating   Lounge Area	
Dressing Gown & Slippers	
Complimentary Toiletries	
Tea & Coffee making facilities	
Fridge	
In-room Safe	
Hair Dryer	
Iron & Ironing Board upon request	
Minibar (stocked on request)	
Choice of King-size, Double or Twin Bed	
Full use of all hotel facilities	
Hot Tub	
Family Friendly	

DISCOVER THE SHEER  
INDULGENCE OF  
OPULENT SUITES THAT  
WILL MAKE YOU FEEL  
LIKE ROYALTY

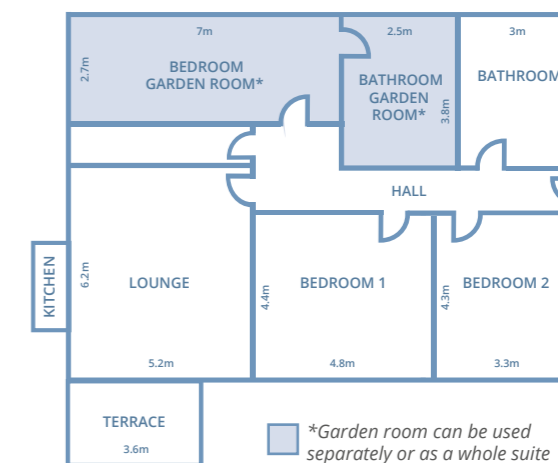

## VICTORIA SUITE

### SUITE DREAMS AWAIT

Our Victoria Suite consists of two sea view bedrooms, a spacious sitting room with garden and sea views, bath, walk-in shower and luxury suite extras. It can be made into three bedrooms with an interconnecting bedroom, each with a 6FT double bed, which can be made into twin beds on request. This spacious suite is perfect for those looking to bring all the family or if you're after some added luxury.



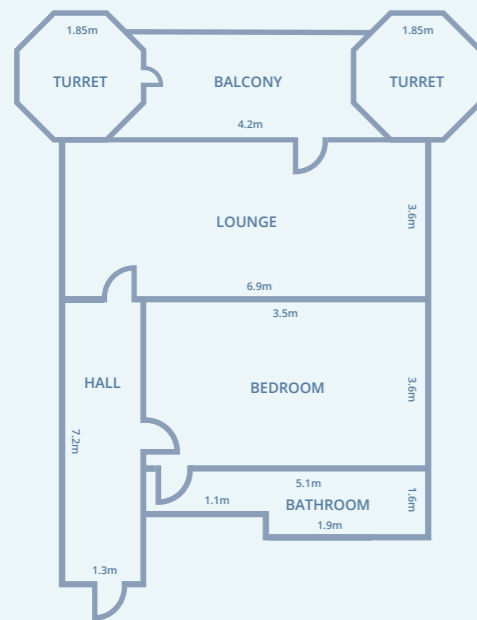

## BETJEMAN SUITE

### LAY YOUR HEAD IN LUXURY

A delightful luxury suite, full of character and with two turret rooms on the balcony which make a wonderful place to sit and enjoy the outstanding sea views from the comfort of your room. With its own sitting room, bath, walk-in rainfall shower, electric fire and luxury suite extras.

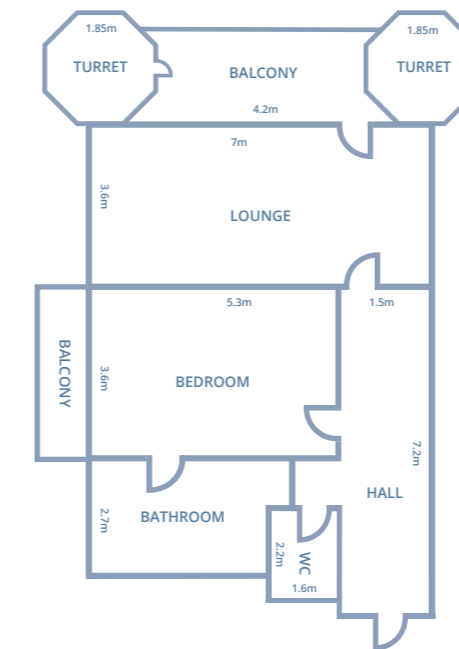

## CONNAUGHT SUITE

### SPECTACULAR IN EVERY WAY

Designed for a luxurious getaway our Connaught suite is the perfect place to hunker down and indulge. This sensational suite boasts outstanding features including two balconies, both with panoramic sea views as well as two charming turret rooms on the balcony. With a spacious bathroom boasting not one but two sinks, bath and walk-in rainfall shower, as well as a comfortable sitting room with TV, electric fire and luxury suite extras.





## STATE ROOMS

### LAVISH ROOMS WITH GLORIOUS SEA VIEWS

Our State rooms ooze style and comfort, from the extra wide six-foot double bed and cosy armchairs, to the tasteful lighting and soft furnishings. Our State room boasts elegance and charm, which includes fresh flowers, fresh fruit, fluffy bathrobes and Brend chocolates on arrival. And the icing on the cake is the view of Lyme Bay, which you can enjoy from the comfort of your own private balcony.

## DELUXE ROOMS

### THE DEFINITION OF COASTAL OPULENCE

These are bright and airy rooms with plenty of space and light, featuring sumptuous beds and armchairs, and stylish decor highlighted with splashes of gold. All have gleaming en suite bathrooms, most have direct sea views and some have their own private balcony. Additionally, all rooms are finished with freshly cut flowers by our in-house floristry team and luxury extras.





## SUPERIOR ROOMS

### LUXURIOUS ROOMS WITH OUTSTANDING COASTAL VIEWS

The bright, warm decor of these stylish luxury rooms makes the most of the beautiful light that reflects off the sea. You'll find superbly comfortable beds with crisp linen, elegant furnishings and modern en suite bathrooms, plus complementary finishing touches like fresh flowers and luxury toiletries.



## SEA VIEW ROOMS

### THE PERFECT BASE FOR AN AMAZING DEVON HOLIDAY

Slightly smaller than our Superior Rooms, they are all beautifully finished and benefit from direct sea views across the glorious setting of Lyme Bay. The perfect oasis where you can relax and unwind, with cosy beds and furnishings, private bathrooms and all the facilities you need.







## GARDEN / PARTIAL SEA VIEW ROOMS

### ELEGANT, LUXURIOUS AND CHARMING

These rooms do not have direct sea views, but they do have pretty views across our grounds or towards the charming Regency town of Sidmouth. They are all sumptuously decorated and beautifully furnished, with lovely warm colours and stylish fittings, as well as a sparkling en suite bathroom.



## STANDARD DOUBLE ROOMS

### BEAUTIFULLY FURNISHED ROOMS

Excellent value for money, but with all the quality and luxury that you would expect from the Brend Collection. Your beautifully furnished room comes with a wonderfully comfortable bed made up with crisp white linen and a sparkling en suite bathroom. Due to the construction of the new lift, two of these Standard Double Rooms have restricted views, but both have a walk-in shower and are situated near to the new lift.





## DELUXE SINGLE ROOMS

### IDEAL FOR SINGLE TRAVELLERS

These sumptuous singles are equipped to the same high standard as the rest of our luxury accommodation. If you require a single with a slightly roomier bed, then please ask our staff at the time of booking.

- SLEEPS 1
- 
- 
- 
- 
- 
- 
- 
- 
- 
- 

## STANDARD SINGLE ROOMS

### LUXURY ACCOMMODATION AS STANDARD

All our standard single rooms offer the same high standards as our deluxe single rooms, with modern furnishings, finishing touches with some offering a larger double bed.

- SLEEPS 1
- 
- 
- 
- 
- 
- 
- 
- 
-

SELF-CONTAINED SUITES  
BOASTING LARGE FRENCH  
WINDOWS OPENING ONTO  
PRIVATE POOLSIDE TERRACES  
WITHIN THE OUTDOOR POOL  
COMPLEX, LESS THAN 100M  
FROM THE HOTEL ENTRANCE



## IDYLLIC FAMILY HOLIDAYS

### ROOM FOR ALL THE FAMILY

Imagine waking up and being able to step out of the large French doors onto your own private poolside terrace, each with 2 sun loungers, a table and chairs to seat 4, private hot tub and stepping out to our outdoor pool. Make memories that will last a lifetime with our outstanding Poolside Suites.

Comfortable for two adults and two children, the Poolside Suites have a separate living area and small kitchen area, for added independence for your family. Each Poolside Suite has its own private terrace overlooking the pool, which has been designed with the safety of small children in mind.

Each sleeps up to 2 adults and 2 children with room for a cot.

*A minimum 3-night stay is required for hot tub use.*





## POOLSIDE SUITES 1

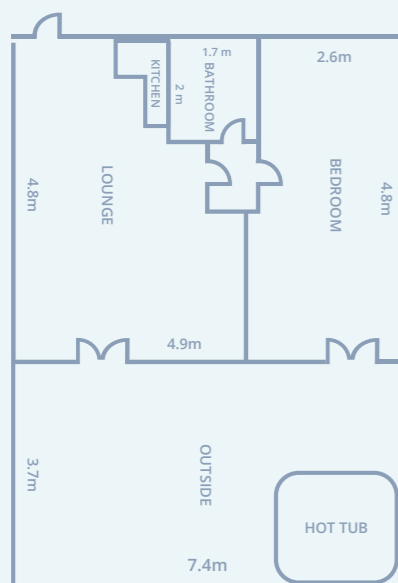

### DIVE INTO LUXURY

The detached suite is set beside the outdoor pool, offering you the closest proximity to the pool whilst giving self-contained privacy.



*A minimum 3-night stay is required for hot tub use.*



## POOLSIDE SUITES 2 & 3

### LUXURY & SPACE IN ABUNDANCE

These semi-detached interconnecting suites are an ideal solution for a larger family holiday, able to accommodate two generations when connected. Alternatively, each suite can be self-contained for one smaller family or couple. Each suite has a separate WC and bathroom to offer privacy between rooms.

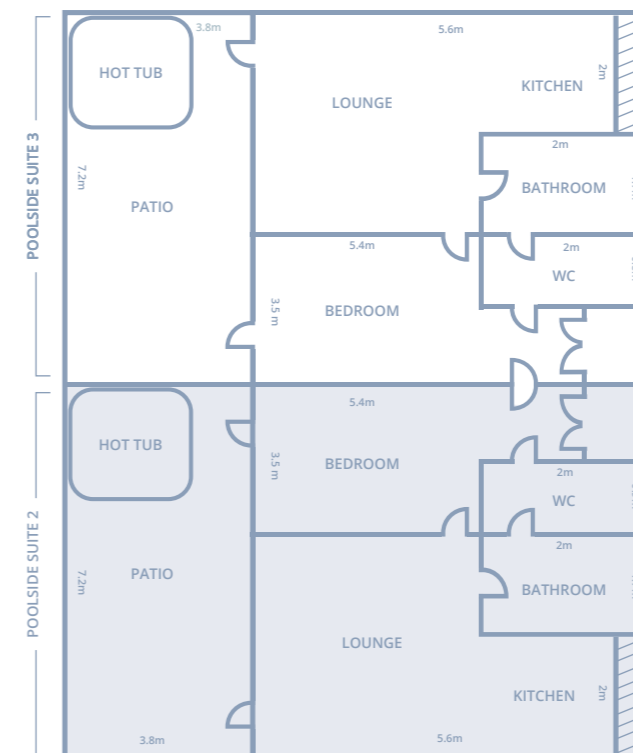

*A minimum 3-night stay is required for hot tub use.*

# GENERAL INFORMATION

---

## ARRIVAL & DEPARTURE

Rooms are available from 3.00pm on the day of arrival, and Poolside Suites are available from 4.00pm. On the day of departure please vacate your room by 11.00am and Poolside Suites need to be vacated by 10.00am.

## POOLSIDE SUITES

Poolside Suites are let on a room only basis, but you're welcome to book meals in advance (times will be confirmed on arrival). Room Service is not available in the Poolside Suites.

## GRATUITIES

The Victoria Hotel operates a traditional franc system for gratuities, which may be added to the final bill, and are left entirely at guests' discretion. They are shared amongst all staff and specifically are not for the benefit of the company.

## LEISURE

The Victoria Hotel benefits from an extensive range of excellent leisure facilities. Our Source Spa features a heated indoor pool, spa bath, sauna, steam room, gym and relaxation area.

Our two treatment rooms offer a diverse range of Source spa treatments, and early booking is recommended for these. Outdoors we have a large heated swimming pool, a smaller children's pool, tennis court and an 18-hole putting green.

Note: Whilst the Hotel Management takes every care to ensure the safety of guests at all times, we cannot take responsibility for supervision of children. Parents must supervise their child at all times, particularly around the indoor and outdoor pool areas.

## OUTDOOR POOLS

The outdoor pools are open from Whitsun until the end of September (weather permitting).

## DOGS

In the interest of hygiene the hotel does not accept dogs, other than service dogs.

## JUBILEE RESTAURANT

We have luxury table d'hôte and à la carte menus. Meals can also be taken at any other Brend Hotel by prior arrangement with the hotel receptions. Unfortunately, no allowance can be made for meals not taken.

**Breakfast:** 8am - 10am

**Lunch:** 12.30pm - 1.30pm

**Sunday Lunch:** 12.30pm - 1.30pm

**Afternoon Tea:** 3.30pm - 5.30pm

**Dinner:** 6.30pm - 8pm

**Dress code:** In the evening, we have a more formal dress code. It is expected that guests change for dinner and dress for the occasion with most guests preferring to follow the jacket and tie guideline. This is purely a guideline and is mentioned as a helpful indicator so guests feel comfortable and know what they may expect to find. We ask simply, as a courtesy to others, to respect an atmosphere that most guests prefer. (No ripped denim, sportswear, beachwear or trainers).

For those not wanting a formal dining experience, the White Room is available (booking recommended). Special times for children's meals are arranged, see the duty receptionist. Drinks and light refreshments are available 24 hours a day.

## THE WHITE ROOM RESTAURANT

Our White Room restaurant offers dining in a more informal atmosphere, yet still being able to enjoy the wonderful dishes that our Executive Head Chef, Stuart White, and his team create. Guests on dinner inclusive terms may dine from the table d'hôte menu.

**Dress code:** Smart casual (no beachwear).

## FOOD ALLERGIES

If you suffer from any form of food allergy, please discuss this with a member of staff who will be happy to advise our chefs to arrange your meals accordingly.

## GENETICALLY MODIFIED FOODS

The company operates a policy of not knowingly using genetically modified foods.

## WINDOWS AND BALCONIES

We draw your attention to the dangers of open windows and balconies in rooms where there are small children, and ask all parents to be mindful of the risk of an accident. As part of the company's policy on health and safety some of our bedroom windows have been fitted with restrictors. However, should you wish to have these removed during your stay, please contact reception.

## CHRISTMAS & NEW YEAR

Please ask for our special Christmas and New Year programme and tariff.

## MEDICAL SERVICES

Can be contacted through Reception. Unless there is an emergency, guests may be asked to speak to the Health Centre to arrange an appointment.

## BEDROOM ACCOMMODATION

Completed in 1903 as a purpose-built hotel, The Victoria has since kept pace with changing standards by careful modernisation, in keeping with its Victorian origins. As you will see from our tariff, the various rates reflect the size and aspect of each room category. All rooms are tastefully furnished and have a private bathroom en-suite, digital television with Freeview, radio, telephone and free Wi-Fi. The Company's policy is continual improvement, many bedrooms receiving comprehensive attention each year.

## SMOKING POLICY

The Victoria Hotel operates a non-smoking policy throughout the building, including e-cigarettes.

## FIRE SAFETY

This hotel is fitted with the latest fully addressable fire alarm systems. Please make yourself aware of the fire exits and full fire emergency procedures, which are displayed in your room.

## EV CHARGERS

We have 2 EV chargers on site. Smappee makes it easy for guests to use renewable energy more efficiently via one interconnected app, allowing you to track both your charging and costs in real-time within the app. To make your arrival as seamless as possible we suggest downloading the app ahead of time, via the relevant links on our website: [victoriahotel.co.uk/news/ev-chargers](http://victoriahotel.co.uk/news/ev-chargers)

## DISABILITIES & MEDICAL CONDITIONS

Please let Reception know if you have any disability or medical condition that could affect your health, safety and welfare during your stay.

## LAUNDRY

The hotel has an excellent laundry service for guests. Please give your laundry to your room attendants by 9.00am. An express dry cleaning service is also available. Shoe cleaning services are available at all times.

## VALUABLES

Unfortunately, the management cannot accept responsibility for the loss of or damage to any article or articles of value, unless they are deposited at the Reception office for safe custody and an official receipt obtained. All of our rooms do have safes.

## CANCELLATION

For details of our Terms & Conditions, please scan the QR code below. All room rates quoted are inclusive of VAT at the current rate. All major credit cards accepted. Cheques payable to: P R Brend & Sons (Hoteliers) Ltd

## HOTEL ACCESS POLICY

For more information visit; [www.victoriahotel.co.uk/hotel-access](http://www.victoriahotel.co.uk/hotel-access)







# Victoria

HOTEL & SOURCE SPA

[www.victoriahotel.co.uk](http://www.victoriahotel.co.uk)



The Esplanade, Sidmouth, Devon EX10 8RY

Hotel Enquiries 01395 512651 | [reservations@victoriahotel.co.uk](mailto:reservations@victoriahotel.co.uk)

Spa Enquiries 01395 576006 | [reception@sourcespa.co.uk](mailto:reception@sourcespa.co.uk)



# B R E N D

COLLECTION

HOTELS | RESTAURANTS | SPAS

If you would prefer not to receive future mailers from us  
please e-mail [reservations@victoriahotel.co.uk](mailto:reservations@victoriahotel.co.uk)